

330 MARSHALL STREET, LANSING, MI 48912
UP TO 20,000 SF AVAILABLE

**FOR
LEASE**



PATRICK T. GILLESPIE

Business Development Analyst
ptgillespie@gillespie-group.com
517-333-4123

CONTACT US

330 Marshall St. Suite 100
Lansing, MI 48912
517-333-4123
gillespie-group.com

ANABEL STANTON

Commercial Sales & Leasing Coordinator
AStanton@gillespie-group.com
517-333-4123



FOR LEASE

330 MARSHALL STREET, LANSING

PROPERTY DETAILS

Address:	330 Marshall Street, Lansing, MI, 48912
Lease Rate:	\$18.50/SF, NNN *Includes parking
Year Built:	1924
Amenity:	Conference room available for daily rental
Information:	Originally constructed in 1924 to serve the Michigan National Guard, the Marshall Street Armory is a landmark rich in history and architectural character. Once a hub for military training and equipment storage, the building has since been thoughtfully transformed into a modern workspace while preserving its historic integrity.

The building's unique design elements, arched windows, exposed brick, and high ceilings create a one-of-a-kind atmosphere. Tenants will also have a marquee signage opportunity.

AREA DESCRIPTION

Situated just east of Lansing's downtown core and minutes from Michigan State University's campus and East Lansing, the Marshall Street Armory is ideally located within a growing corridor of civic, residential, and business activity. The building offers convenient access to major highways (US-127), nearby government buildings, and local amenities—including coffee shops, restaurants, and event spaces. Just blocks from the Michigan State Capitol, the location blends the energy of an urban setting with the comfort of a neighborhood feel. Whether you're hosting clients, meeting with partners, or stepping out for a midday break, the surrounding area provides the connectivity and convenience that support both productivity and lifestyle.



PARKING
ONSITE PARKING INCLUDED

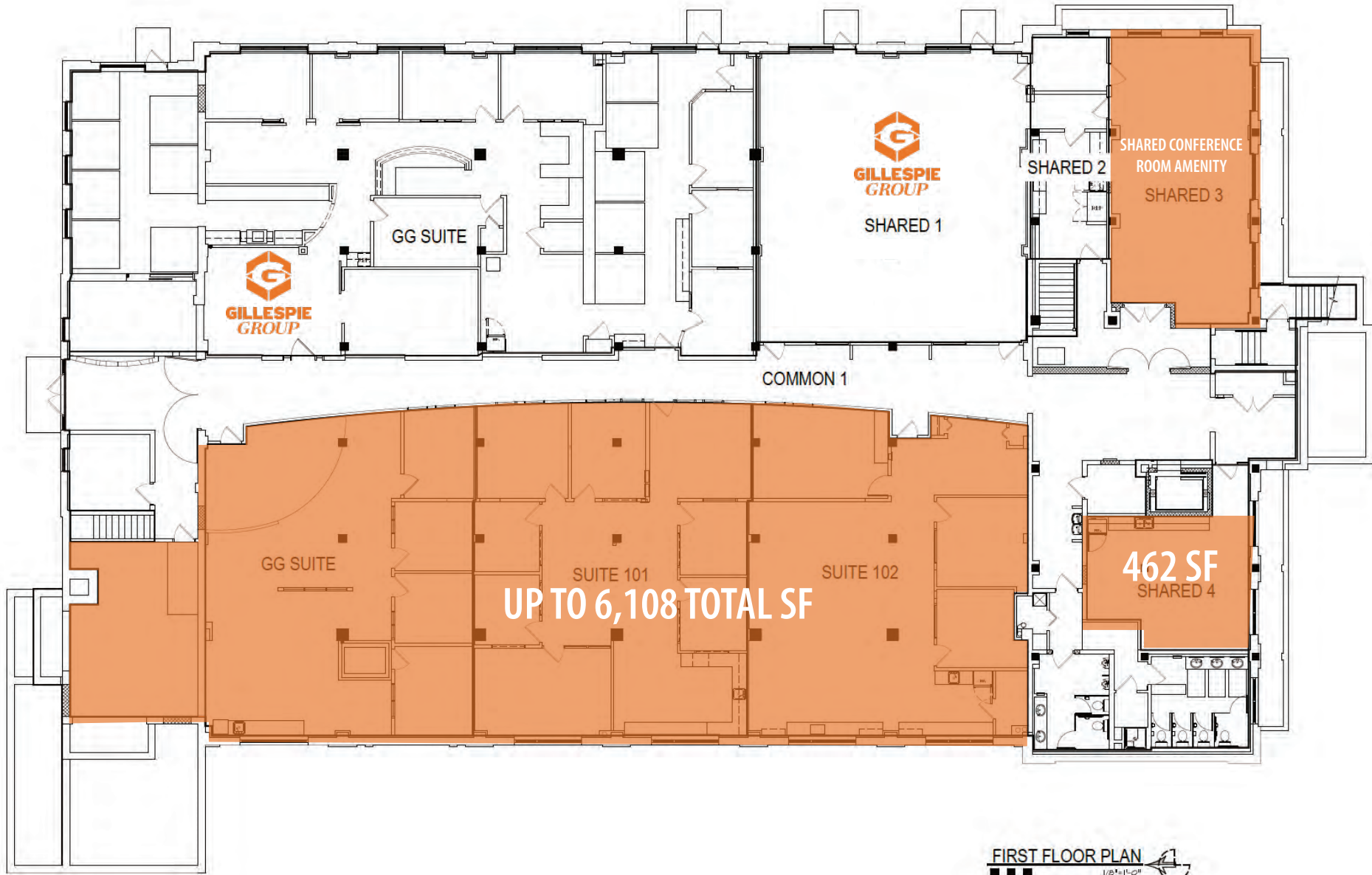

UP TO 6,108 TOTAL SF

FIRST FLOOR PLAN
1/8" = 1'-0"

FIRST FLOOR PLAN

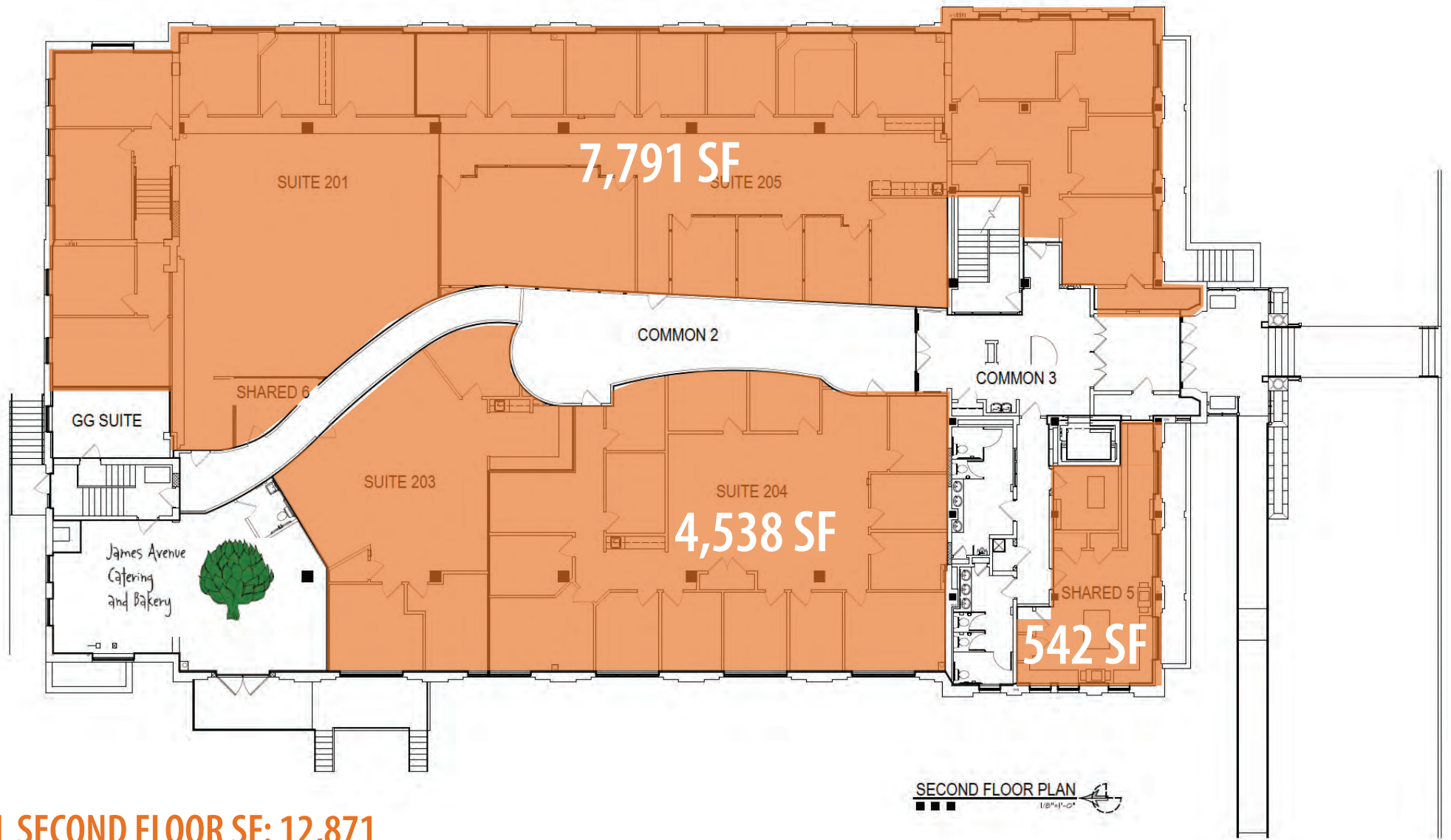

TOTAL SECOND FLOOR SF: 12,871

SECOND FLOOR PLAN



EXTERIOR PHOTO GALLERY



SECOND FLOOR



SHARED CONFERENCE ROOM



FIRST FLOOR



FIRST FLOOR

INTERIOR PHOTO GALLERY



SIGNAGE OPPORTUNITY

KEYED AMENITIES

- | | | |
|-------------------------------|--------------------------------|------------------------------|
| 1 LANSING CENTER | 7 CHURCH OF THE RESURRECTION | 14 WLNS TELEVISION |
| 2 JACKSON FIELD | 8 LANSING CATHOLIC HIGH SCHOOL | 15 LANSING HEALTH CENTER LAB |
| 3 CAPITAL CITY MARKET | 9 EASTERN HIGH SCHOOL | 16 FRANDOR SHOPPING CENTER |
| 4 SPARROW HOSPITAL | 10 GROESBECK GOLF COURSE | 17 AC HOTEL LANSING |
| 5 LANSING OCCUPATIONAL HEALTH | 11 SPEEDWAY | |
| 6 SOUP SPOON CAFE | 12 PEOPLE'S KITCHEN | |
| | 13 FELDMAN CHEVROLET LANSING | |

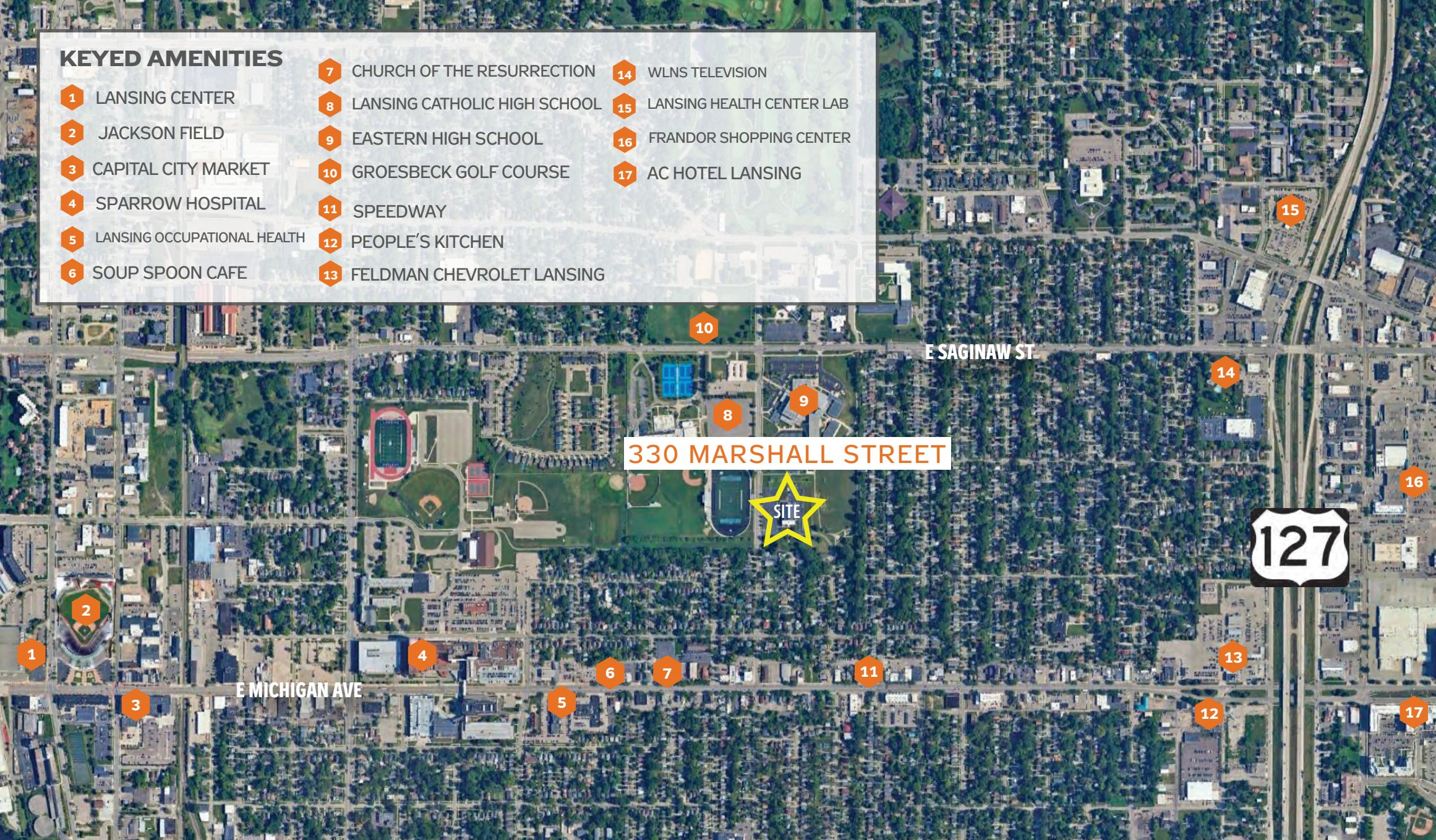

330 MARSHALL STREET

SITE

CONTEXT MAP