

637 E. MICHIGAN AVE, LANSING MI - SUITE B 4,027 SF

FOR
LEASE



CONTACT US

330 Marshall St. Suite 100
Lansing, MI 48912
517-333-4123
gillespie-group.com

PATRICK T. GILLESPIE

Business Development Analyst
ptgillespie-group.com
517-333-4123

GILLESPIE GROUP
LANSING

FOR LEASE

637 E. MICHIGAN AVE SUITE B

PROPERTY DETAILS

Address:	637 E. Michigan Ave, Lansing, MI 48912
Lease Rate:	Rental rate built on landlord/tenant negotiations and tenant improvement specifications
Building SF:	4,027
Year Renovated:	2022
Information:	The property features new windows, roof, outdoor seating and patio space, and a separate entry vestibule. Surface parking is available at the doorstep, with prominent street and building signage for maximum visibility.

AREA DESCRIPTION

Located in the heart of the Stadium District of Downtown Lansing 637 E. Michigan Avenue offers an unparalleled opportunity to establish your business in a thriving and vibrant area. This location sits just blocks from the Michigan State Capitol and benefits from being in a downtown district that welcomes over 3.5 million annual visitors to its events, attractions, and businesses. The property is conveniently close to notable tenants and attractions, including Starbucks, Courtyard Lansing Downtown, Choose Lansing , Lansing Brewing Company, Jackson Field (home to the Lansing Lugnuts), and Capital City Market.

The surrounding area is home to a dynamic mix of professional offices, retail establishments, and dining options, creating a robust commercial environment. Lansing's population has grown to over 117,000 residents, with the greater metropolitan area exceeding 550,000 people, ensuring a steady flow of potential customers and clients. Additionally, the property enjoys proximity to major transportation routes, including easy access to I-496 and US-127, making it a prime location for businesses seeking visibility and convenience.

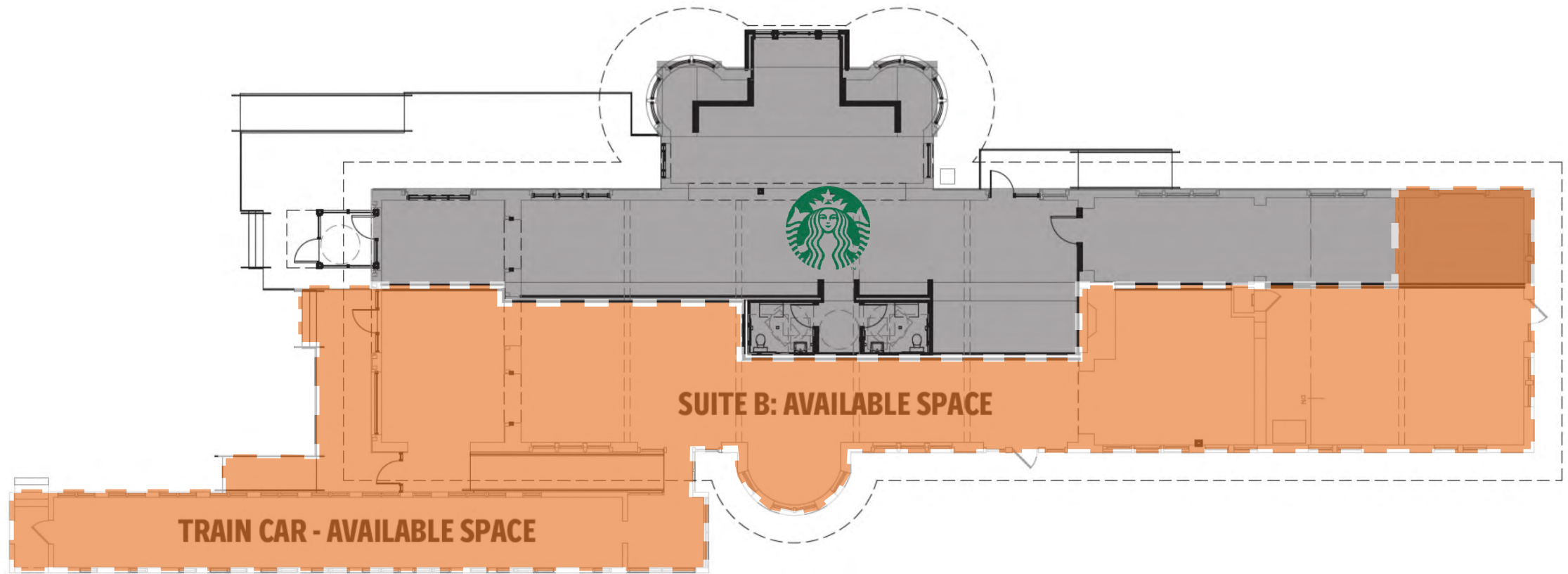

FLOOR PLAN



SCHEMATIC RESTAURANT FLOOR PLAN

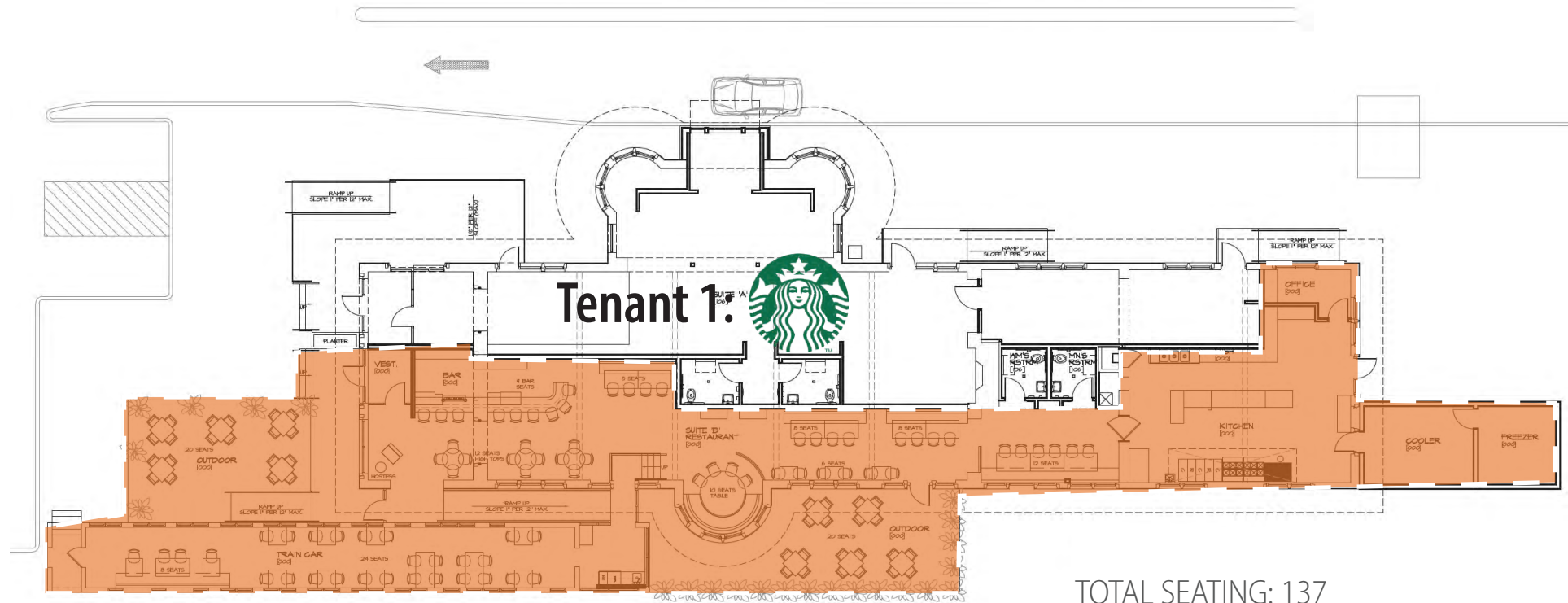

TOTAL SEATING: 137
(INCLUDING PATIO SEATING)



FIRST FLOOR PLAN
1/8" = 1'-0"

RESTAURANT FLOOR PLAN

CURRENT LAYOUT



SITE PLAN

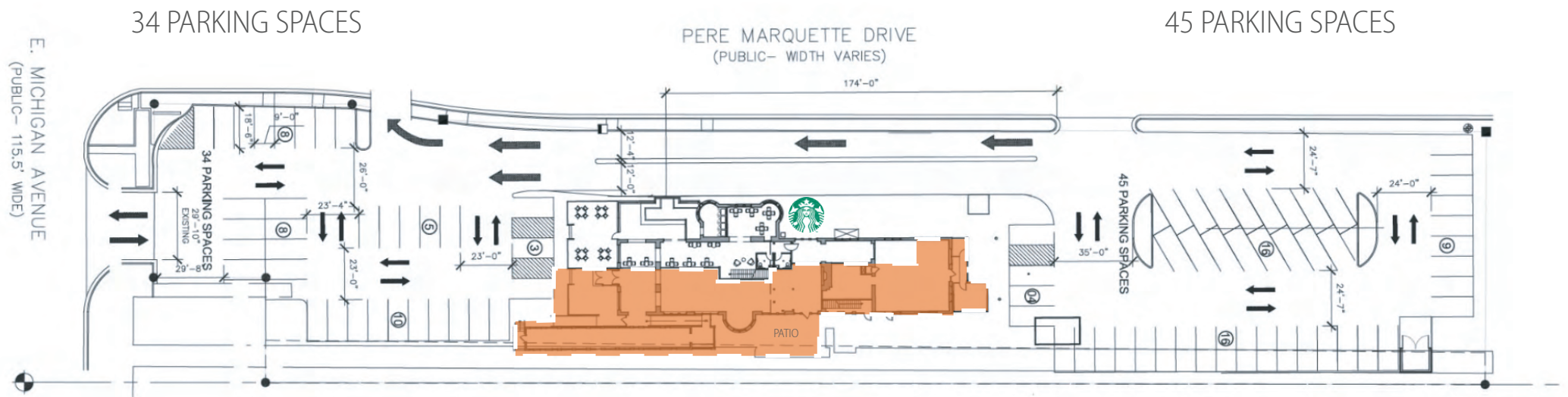

SITE PLAN



PARKING

150 TOTAL SPACES AS HIGHLIGHTED



PHOTO GALLERY



KEYED AMENITIES

- 1 MP SOCIAL
- 2 LANSING SHUFFLE
- 3 SPARROW BLOOM
- 4 TINY BIT OF WOOD
- 5 MICHIGRAIN DISTILLERY
- 6 THE HUMMINGBIRD
- 7 LANSING BREWING COMPANY
- 8 JACKSON FIELD
- 9 AMERICAN FIFTH
- 10 STARBUCKS
- 11 BOWDIE'S CHOPHOUSE
- 12 NUTHOUSE
- 13 SIDECAR SLIDER BAR
- 14 NOTRE DAME FEDERAL CREDIT UNION
- 15 BIGGBY
- 16 STATE OF FITNESS
- 17 CAPITAL CITY MARKET
- 18 COURTYARD BY MARRIOTT

CONTEXT MAP