

637 E. MICHIGAN AVE, LANSING MI - SUITE B 4,027 SF

FOR  
LEASE



PATRICK T. GILLESPIE

Business Development Analyst  
ptgillespie-group.com  
517-333-4123

CONTACT US

330 Marshall St. Suite 100  
Lansing, MI 48912  
517-333-4123  
gillespie-group.com

JAYDEN SOLES

Commercial Leasing Specialist  
jsoles@gillespie-group.com  
517-333-4123

  
**GILLESPIE GROUP**  
LANSING

# FOR LEASE

# 637 E. MICHIGAN AVE SUITE B

## PROPERTY DETAILS

Address:	637 E. Michigan Ave, Lansing, MI 48912
Lease Rate:	Rental rate built on landlord/tenant negotiations and tenant improvement specifications
Building SF:	4,027
Year Renovated:	2022
Information:	The property features new windows, roof, and a separate entry vestibule. Surface parking is available at the doorstep, with prominent street and building signage for maximum visibility.

## AREA DESCRIPTION

Located in the heart of the Stadium District of Downtown Lansing 637 E. Michigan Avenue offers an unparalleled opportunity to establish your business in a thriving and vibrant area. This location sits just blocks from the Michigan State Capitol and benefits from being in a downtown district that welcomes over 3.5 million annual visitors to its events, attractions, and businesses. The property is conveniently close to notable tenants and attractions, including Starbucks, Courtyard Lansing Downtown, Choose Lansing, Lansing Brewing Company, Jackson Field (home to the Lansing Lugnuts), and Capital City Market.

The surrounding area is home to a dynamic mix of professional offices, retail establishments, and dining options, creating a robust commercial environment. Lansing's population has grown to over 117,000 residents, with the greater metropolitan area exceeding 550,000 people, ensuring a steady flow of potential customers and clients. Additionally, the property enjoys proximity to major transportation routes, including easy access to I-496 and US-127, making it a prime location for businesses seeking visibility and convenience.

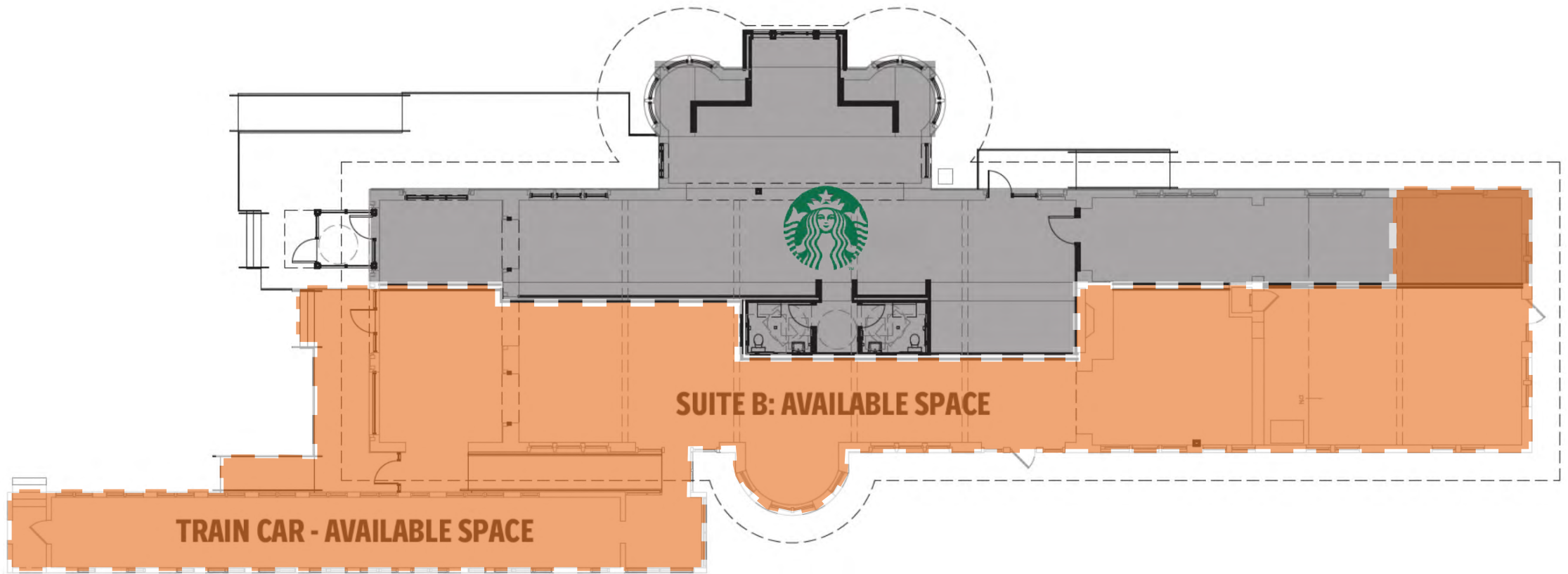

# FLOOR PLAN



# SCHEMATIC RESTAURANT FLOOR PLAN

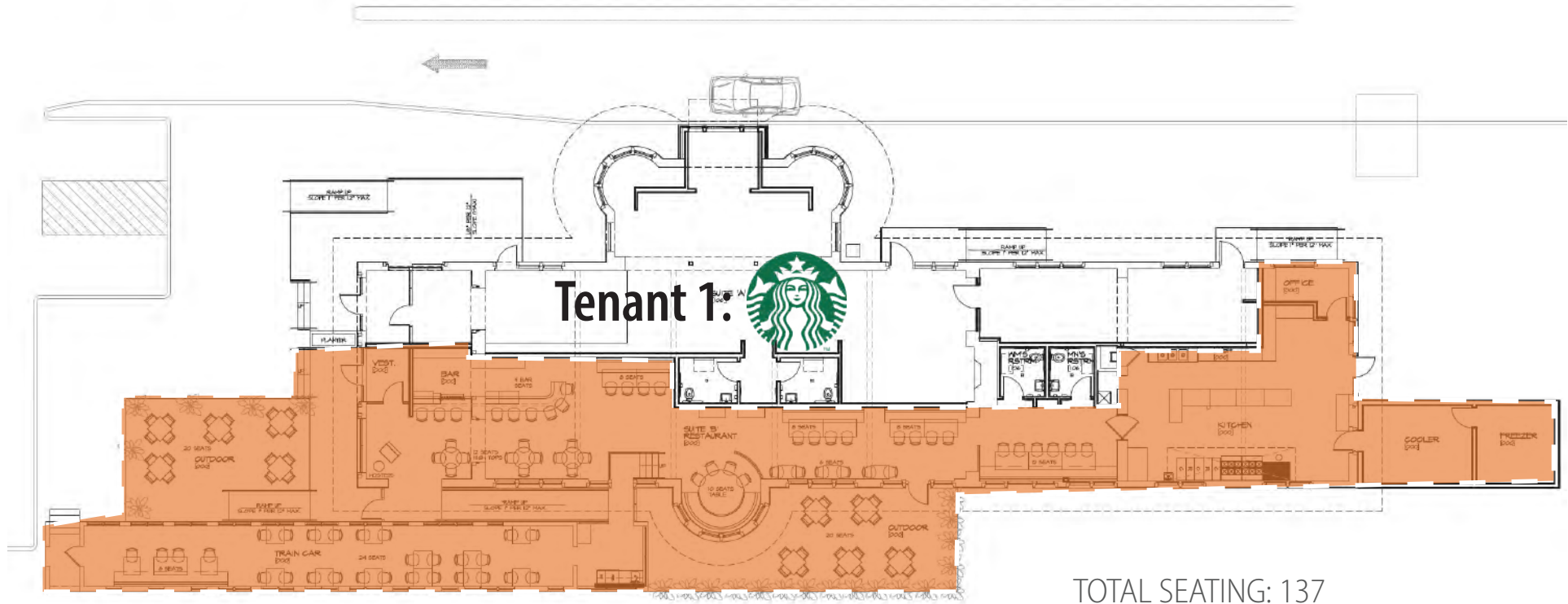

TOTAL SEATING: 137  
(INCLUDING PATIO SEATING)



FIRST FLOOR PLAN  
1/8" = 1'-0"

## RESTAURANT FLOOR PLAN CURRENT LAYOUT



# SITE PLAN

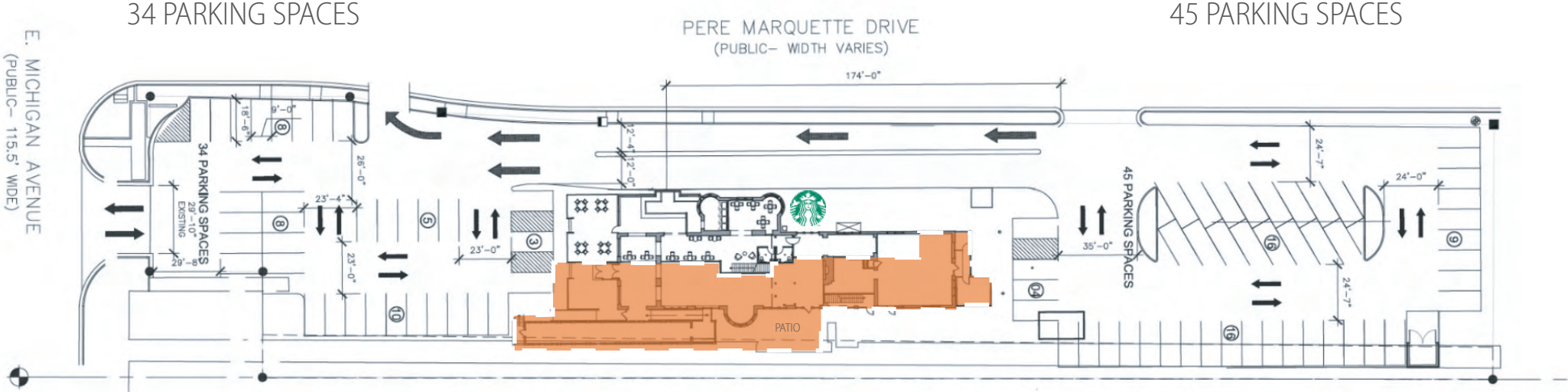

# SITE PLAN



# PARKING

150 TOTAL SPACES AS HIGHLIGHTED



# PHOTO GALLERY



## KEYED AMENITIES

- 1 MP SOCIAL
- 2 LANSING SHUFFLE
- 3 SPARROW BLOOM
- 4 TINY BIT OF WOOD
- 5 MICHIGRAIN DISTILLERY
- 6 THE HUMMINGBIRD
- 7 LANSING BREWING COMPANY
- 8 JACKSON FIELD
- 9 AMERICAN FIFTH
- 10 STARBUCKS
- 11 BOWDIE'S CHOPHOUSE
- 12 NUTHOUSE
- 13 SIDECAR SLIDER BAR
- 14 NOTRE DAME FEDERAL CREDIT UNION
- 15 BIGGBY
- 16 STATE OF FITNESS
- 17 CAPITAL CITY MARKET
- 18 COURTYARD BY MARRIOTT

# CONTEXT MAP