

# Assembly Map

*\*Please note that the location of the assembly area may be subject to change depending on the emergency and this may be communicated verbally by the Property Manager or the Responding Emergency personnel.*

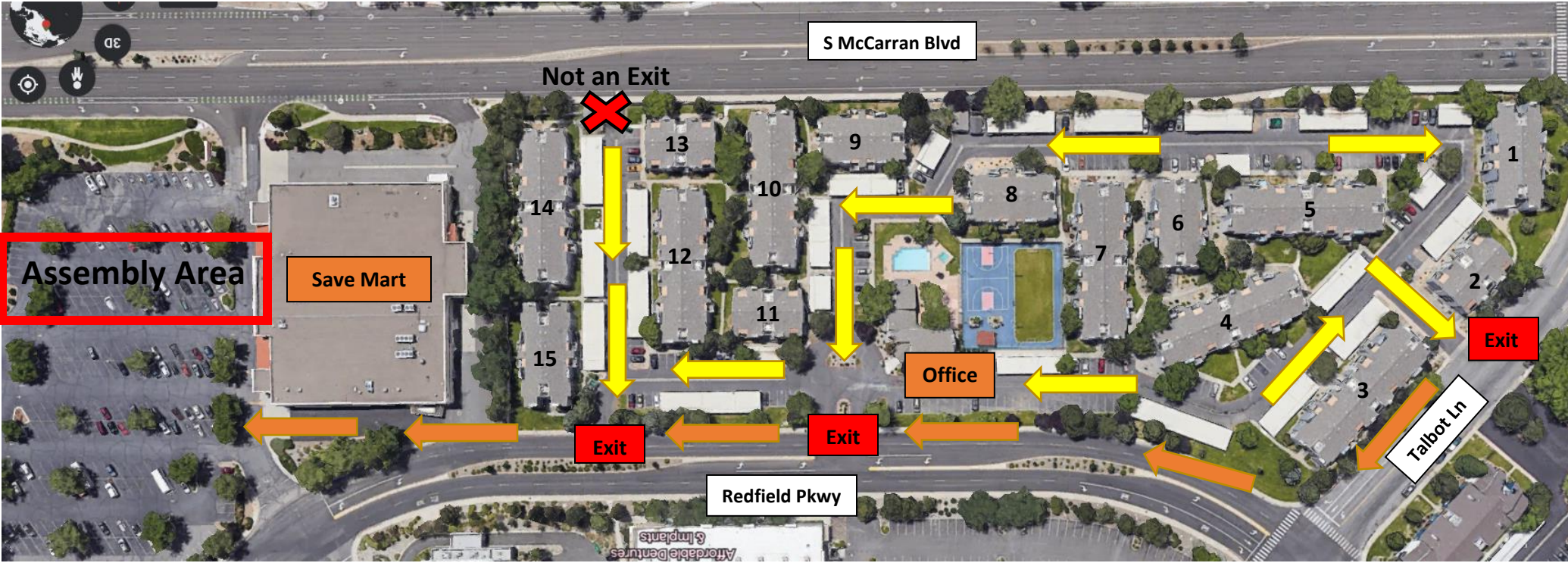

***Follow the yellow arrows from your corresponding building to the nearest property exit to the Save Mart Parking Lot located East of the Office or otherwise directed by local authorities. Please use the sidewalks around the perimeter of the property as indicated by the orange arrows.***

