



40° 59' 53" N    **THE**    73° 39' 56" W

# MAGELLAN

◆ PORT CHESTER ◆



108 S. MAIN STREET  
PORT CHESTER, NY 10573  
[MAGELLANPC.COM](http://MAGELLANPC.COM)

# FEEL AT HOME

Live the way you've always wanted without compromising style or quality. The Magellan, our apartment residences are designed with you in mind. Now you can really have it all...lifestyle included.



0 - 2

Bedrooms



1 - 2

Bathrooms

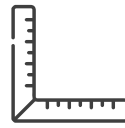

451 - 1,141

Square Feet



VISIT OUR WEBSITE  
TO LEARN MORE

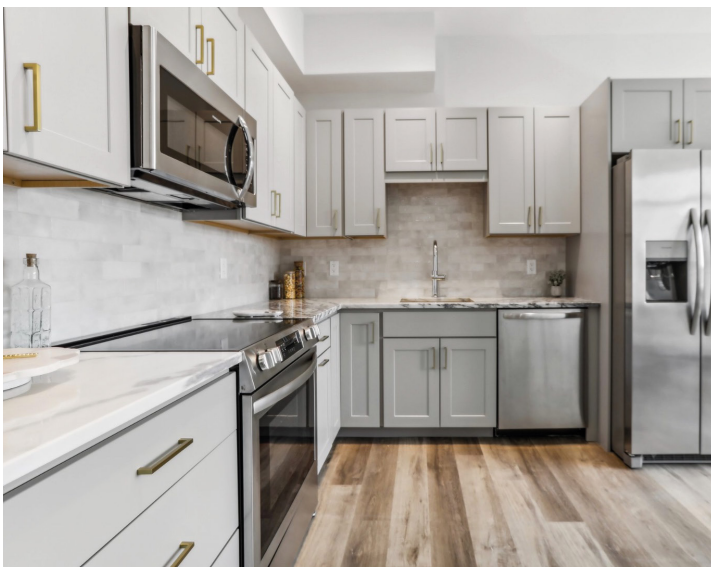

# ESSENTIAL SPACES



## Relax & Refresh

The services and amenities at the Magellan have been carefully selected to elevate your living experience. The Magellan offers a curated collection of wellness and recreational amenities and services. The spaces act as an extension of your home, offering more opportunities to unwind, relax, and enjoy.

Access to these amenities help achieve the perfect work/life balance.



## Rooftop

Explore, entertain and enjoy 5,000 sq ft outdoor rooftop. Plenty of seating under the pergola or bask in the sun. Grills and pizza ovens available for added fun!

## Fitness Center

The 1,500 sq ft fitness center provides best-in-class equipment for cardiovascular health and weight training. Reach your fitness goals without leaving home.

# INSPIRED INTERIORS

## Living Space

Spacious and light-filled living areas are the perfect space to relax and unwind. High ceilings and oversized windows set the stage to make it your own.

- Custom Millwork & Moldings
- Oversized sound attenuated windows
- Custom-built closets
- Fullsize washer lefryer
- Custom roller shades
- High end fixtures



## Kitchen

The heart of every home, beautiful open kitchens are outfitted with everything you need to prepare the perfect meal.

- Entertain quartz countertops
- Stainless steel GE appliance package
- 23" Stainless steel undermount sink
- Moen High Arc pull-down faucet
- Premium cabinetry with soft-close hinges & drawers
- European tile backsplash

## Bath

Simple, elegant bathrooms offer a calm and refreshing retreat. Porcelain tile flooring and custom vanities heighten the experience.

- Custom Vanity with integrated sink
- LED illuminated frameless mirror
- Porcelain tile flooring
- Walk-in showers in select residences



# NEIGHBORHOOD

The Magellan is perfectly situated to offer immediate access to all the local hot spots and necessities. So much to see and do in port cester, right outside your doorstep. Everything is within reach from everyday essentials to dining and entertainment. Explore a collection of our local favorites. Direct access to the port chester train station brings ease and access to nearby destinations.

## Restuarants

- Sergio's Saw Pit
- Telly's Taverna
- Pan America Bakery & Cafe
- Saltaire Oyster Bar and Fish House
- Marianacci's
- Bartaco
- Colony Grill



## Entertainment

- The Capital Theatre
- Clay Art Center
- AMC Port Chester
- Donald M Kendaiill Sculpture Gardens

## Health & Fitness

- Studio Betterway Fit Training
- Crunch Fitness - Port Chester
- DMK Boxing & Fitness
- The Jiu Jitsu Mill
- LA Fitness



## Retail

- Occhicone Fine Leather Goods
- The Waterfront
- Costco Wholesale
- Marshalls
- Michael's

## Transportation

- 48 Mins to Grand Central
- Walkscore 94 "Walker's Paradise"



# TYPICAL STUDIO LAYOUTS 450 - 815 s4 ft



# TYPICAL 1 BR 590- 960 sq ft



# TYPICAL 2 BR 970- 1175 sq ft





# TYPICAL 2 BR 970- 1175 sq ft



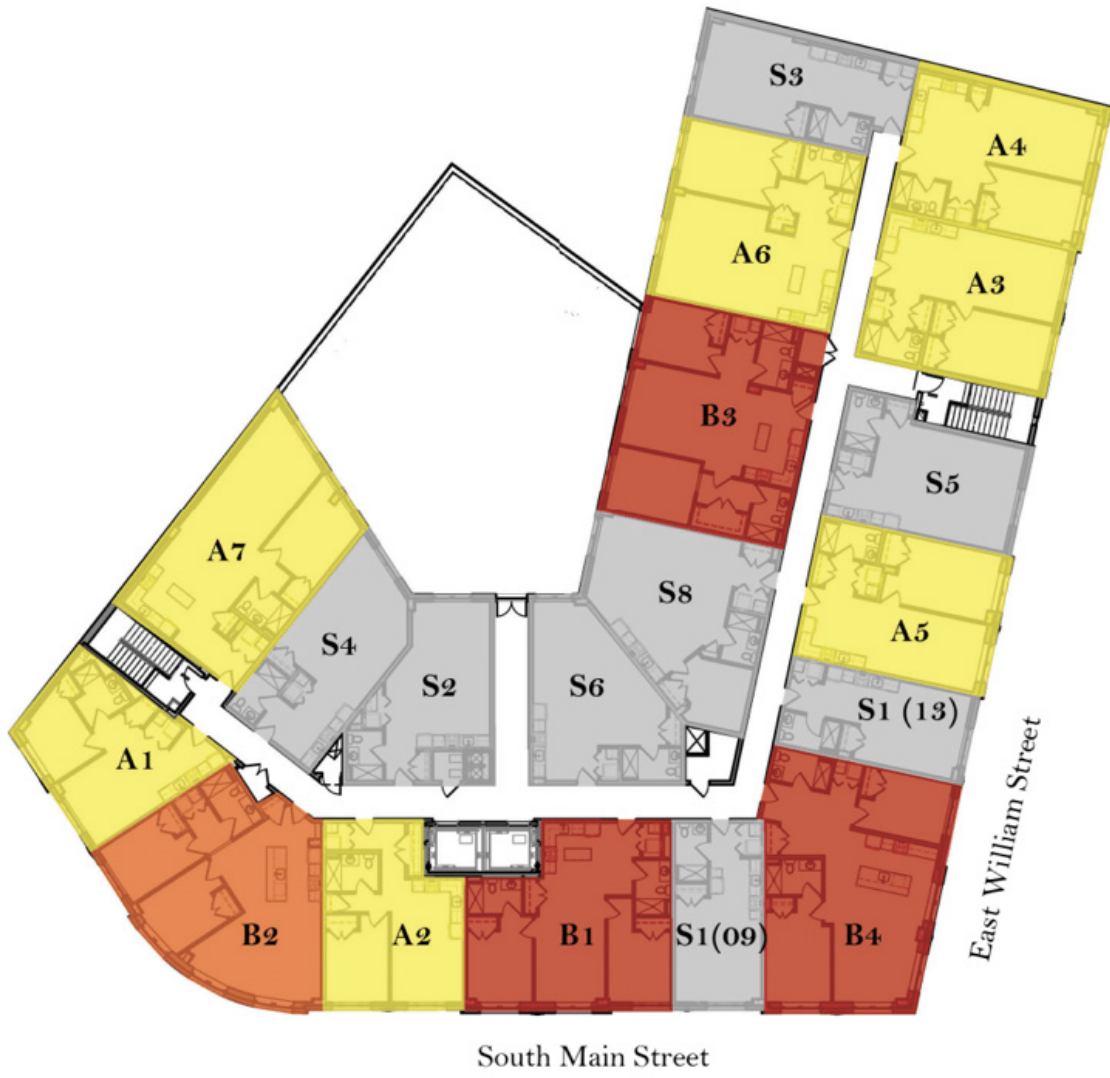

### Unit Type Key

- Studio
- 1 Bed | 1 Bath
- 2 Bed | 1 Bath
- 2 Bed | 2 Bath