



**PACIFICA**  
SENIOR LIVING

FULL-SERVICE RETIREMENT LIVING

It's a New Day.

*And It's Yours!*

The background of the entire page is a light gray, stylized leaf pattern. The leaves are elongated and pointed, with some having small circles at their bases, resembling a repeating botanical motif. This pattern is centered behind a dark blue rectangular box.

## *Our Mission*

Privately owned, Pacifica Senior Living strives to create a lifestyle of independence and peace of mind for each individual and their family. We do what we love and what we truly believe in – providing compassionate, personalized care services with dignity and respect. Our dedicated, professional team supports each resident and goes above and beyond to help them feel at home.

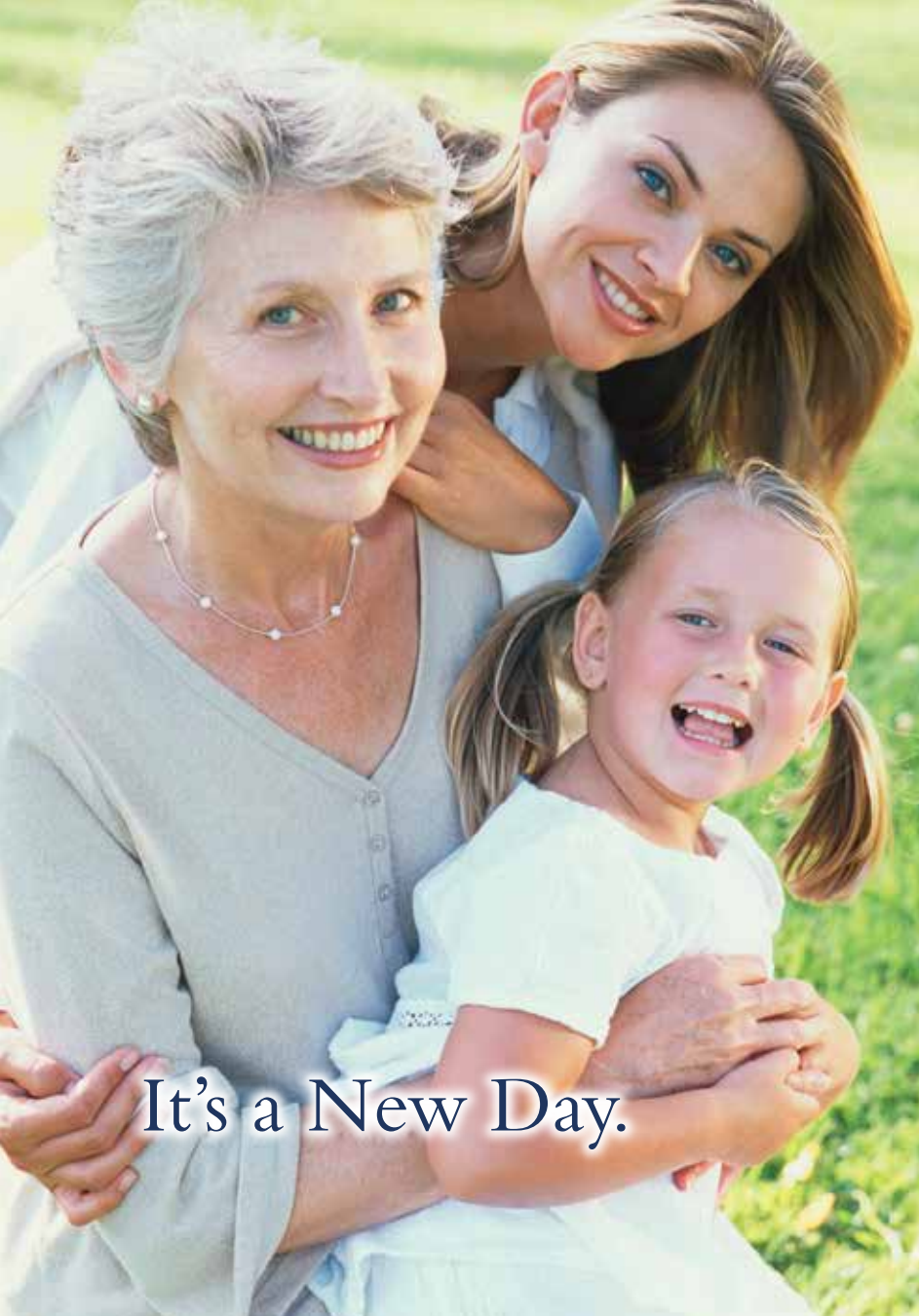

It's a New Day.

At Pacifica Senior Living, we don't expect our residents to "fit" into one of our communities. We've designed our communities to "fit" them – to meet their different needs, preferences, dreams and goals. From independent living to assisted living and memory care, our communities welcome residents to live by their own design.

Our communities provide residents with every service and amenity they need, want and *deserve* to live each day just as they choose. We respect their individuality and understand that each person is in charge of the direction his or her life takes. We're simply here to support them. Every step of the journey.

*And It's Yours!*



# Senior *Living* Services

Pacifica Senior Living communities offer a variety of care and lifestyle choices to support our residents in living well.

## **Independent Living**

Active seniors retire to carefree living at its best. No housework. No yardwork. *No worries.* Just time to spend as they choose. Our communities feature spacious apartment homes, amenities, services and engaging programs – all designed to provide residents with the lifestyle to which they've aspired.

## **Heartland™ Assisted Living**

Delivering the optimal balance of independence and support, Heartland™ Assisted Living helps our residents live fulfilling, dignified lives. Each resident has a customized service plan that meets his or her individual needs. With support available 24 hours a day, our residents enjoy assistance with activities such as:

- Meals
- Medication Management
- Bathing & Dressing
- Mobility
- Transportation



# Welcome

Welcome to Pacifica Senior Living Regency. Our Assisted Living and Memory Care community offers an atmosphere of home and comfort in smaller intimate settings that promote a sense of companionship and sociability.

In our Heartland Assisted Living program, we find the right balance between independent living and the need for more help with personal care to manage daily living routines.

Through our signature program, Legacies Memory Care, we offer those with memory challenges, including Alzheimer's disease and dementia, a supportive and enriching place to call home.

Pacifica Senior Living Regency provides its residents with the care they deserve delivered by a team of compassionate, patient and experienced professionals, complemented by homelike amenities, exceptional services and engaging activity programs.

We offer aging-in-place with continuity of care at every stage. Best yet, we provide families the peace of mind of knowing that their loved ones are in good hands, delivered by people who genuinely care.

At Pacifica Senior Living Regency, it's a new day. ***And it's yours!***



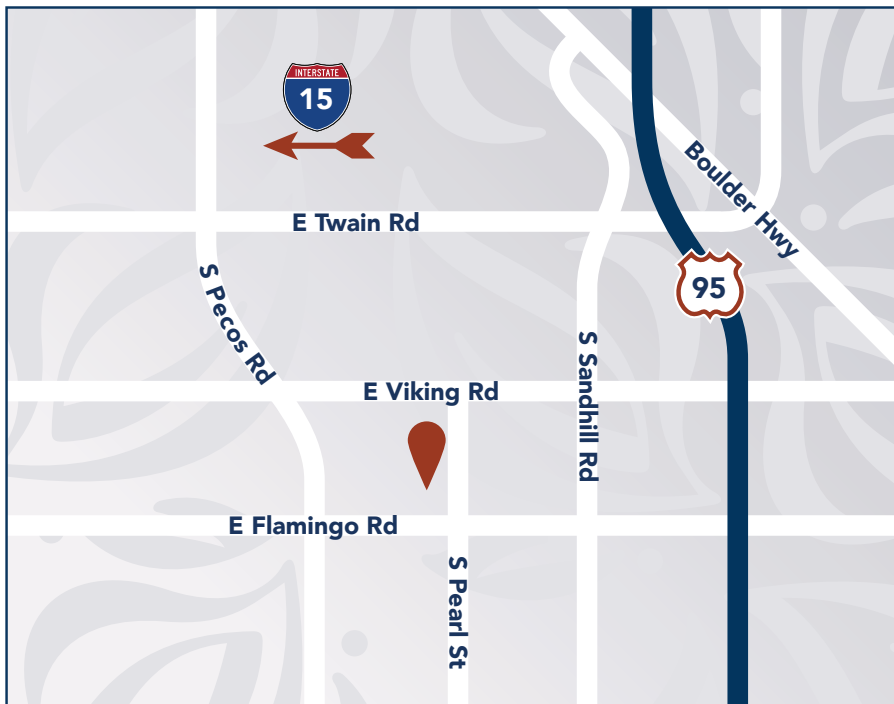

Follow these directions to Pacifica Senior Living Regency senior living community:

*(Please note that we have two separate buildings on Pearl Street)*

### From 1-95/1-515:

- Take the Flamingo Road exit
- Turn west onto Flamingo Road, continue past Sandhill Road
- Turn right (north) onto Pearl Street

### From Green Valley/Henderson:

- Drive north on Pecos Road
- Turn right (east) onto Flamingo Road
- Make first left available (north) onto Pearl Street
- Memory Care is first building on your left
- Continue to second building for Assisted living



# Floor Plans

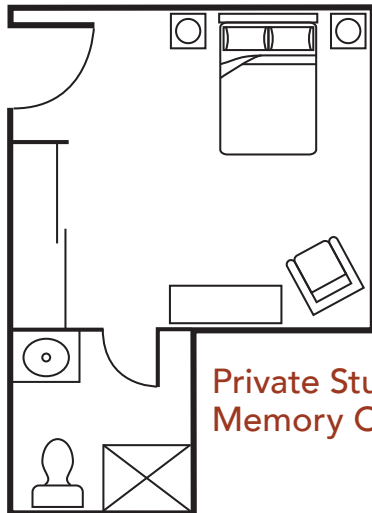

Private Studio  
Memory Care

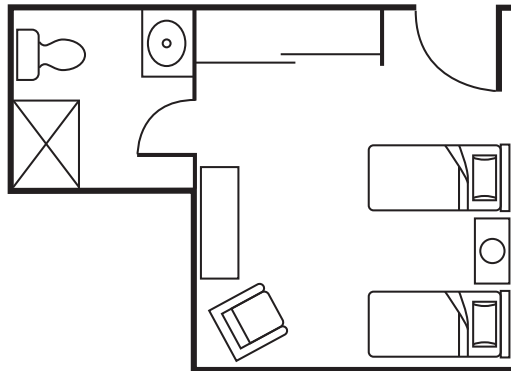

Two-Person  
Shared Suite  
Memory Care



Private Studio  
Assisted Living

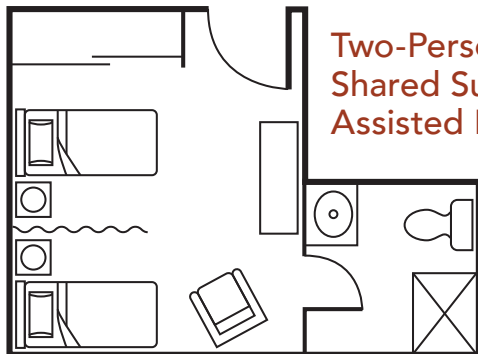

Two-Person  
Shared Suite  
Assisted Living

  
**PACIFICA**  
SENIOR LIVING  
—  
REGENCY  
Assisted Living  
Memory Care



# Legacies™ Memory Care Rates

## Monthly rental fee includes the following Memory Care services and amenities:

- Well trained, professional staff providing 24-hour supervision
- Monthly training of staff
- Assistance with activities of daily living (bathing, dressing, grooming, eating, etc.)
- Supportive and caring environment
- Individualized care plans focusing on personal health concerns
- Medication management
- Three delicious meals daily, plus snacks
- Daily monitoring of nutrition and diet needs
- Wellness Checks
- Specialized programming including groups and one-on-one activities
- Housekeeping, personal laundry and linen services
- All Utilities (except telephone and internet)
- Daily bed making
- Apartment home maintenance

*\*Monthly Level of Care Fee\* based on individual needs assessment and points*

702.436.6400 | 3985 S. Pearl St. | Las Vegas, NV 89121 | [www.PacificaRegency.com](http://www.PacificaRegency.com)





# Heartland™ Assisted Living

The Heartland™ Assisted Living program at Pacifica Senior Living Regency provides seniors with the supportive services they need to continue living as independently and vibrantly as possible.

Our specialized Wellness Team creates a customized, personal care program for each resident based on an assessment conducted with the resident and his or her family prior to move-in, ensuring all needs will be met properly.

Residents are regularly reassessed to make sure the most appropriate support is delivered.

## **Services may include:**

- Medication management: monitoring, supervision or administration
- Bathing, dressing and grooming assistance
- Escort to meals and activity programs
- Toileting
- Mobility
- Health programs
- Medical appointment scheduling
- Wellness checks
- Scheduled transportation



# Heartland™ Assisted Living Rates

## Monthly rental fee includes the following Assisted Living services and amenities:

- Apartment home
- Apartment home maintenance
- 24-hour accessible staff
- Concierge service
- Three nutritious meals served daily in the dining room, plus snacks available anytime
- Life-enrichment programs and activities
- Weekly housekeeping and linen services
- Weekly personal laundry service
- Scheduled transportation and outings
- Community health resource referrals
- All utilities (except telephone)
- Daily bed making

*\*Monthly Level of Care Fee\* based on individual needs assessment and points*



# Respite Care



At Pacifica Senior Living Regency, we admire and respect those who care for their loved one at home. But we also understand the challenges and stresses

faced by a caregiver. There are times when you need a break from your responsibilities to focus on yourself.

Respite Care can provide you with the time and peace of mind you deserve, while providing your loved one with 24-hour care and access to our engaging lifestyle.

This short-term stay option is also ideal for those considering a move to Pacifica Senior Living Regency. Respite Care allows you and your loved one to experience the support and services we provide on a trial basis.

## Respite Care includes:

- A beautiful home-like environment
- Furnished apartment (private or shared)
- Access to 24-hour personal care and assistance
- Three balanced meals and snacks daily
- Weekly housekeeping and personal laundry services

702.436.6400 | 3985 S. Pearl St. | Las Vegas, NV 89121 | [www.PacificaRegency.com](http://www.PacificaRegency.com)



# Legacies™ Memory Care



Our Legacies™ Memory Care Program provides those with Alzheimer's disease, dementia and other forms of memory loss with the support, care and respect they deserve in order to continue living a full, enriching life.

Memory loss affects different people in different ways. Our compassionate and highly trained Wellness Team creates a fully personalized care plan to meet each resident's unique needs, adapting plans as the behaviors associated with memory loss progress or change.

Our specialized approach to memory care is grounded in improving residents' quality of life. Residents engage in many interactive activities that, for example, improve coordination and strengthen social connections.



## Life Enrichment Programs

- Individual and group activities, watching movies, Wii bowling, karaoke, and informative speakers
- Dementia-specific activities, such as memory lane trivia and nostalgia recollections
- Creative arts and music activities that include rhythm, singing and listening
- Exercise programs that include stretching, walking and balance activities; chair exercises for the non-ambulatory
- Stress reducing activities ranging from patterning to sensory stimulation
- Programs that encourage intergenerational relationships and community involvement
- Weekly live entertainment and scheduled outings
- Spiritual opportunities for people of all religions



  
**PACIFICA**  
SENIOR LIVING  

---

REGENCY  
Assisted Living  
Memory Care

702.436.6400 | 3985 S. Pearl St. | Las Vegas, NV 89121 | [www.PacificaRegency.com](http://www.PacificaRegency.com)





## **Legacies™ Memory Care**

Our Legacies™ Memory Care program provides those with Alzheimer's disease, dementia or other forms of memory loss with the support, care and respect they deserve to continue living a full, enriching life. Each resident receives a personalized care plan that is carefully implemented by our compassionate staff.

## **Adult Day Program**

Our Adult Day Program, offered in select communities, is alive with engaging, enriching activities that invite and welcome all seniors to participate. Just as our residents enjoy personalized care, so do our program participants. This is the perfect way to meet new friends and share new experiences.

## **Respite Care**

There are times in our lives when we need a little extra help. Pacifica's Respite Care program is available to allow families an opportunity to rest from the daily tasks required for a loved one. Our program is also perfect for individuals who are recuperating from a hospital/rehabilitation stay, or to just simply experience the Pacifica lifestyle. Trained team members work together to enhance continued dignity and trust. We know the difference a smile and kind word can make.

## **Companion Living**

Companion Living enables seniors to enjoy all the care, services and amenities of a Pacifica Senior Living community with the added benefits of forging a new friendship, enhanced well-being and the cost savings of sharing a suite, just to name a few.

# Designed for *Living Well*

Our communities are designed to help our residents live well, surrounded by services, amenities and programs.

## **Dining**

Dining is a delight at Pacifica Senior Living. Meals are prepared fresh daily by our on-site chefs and are served in beautifully appointed restaurant-style settings by attentive dining room staff.

## **Life Enrichment**

Our Life Enrichment programs offer a variety of opportunities to meet new friends, discover new interests, exercise and maintain health, enjoy exciting outings and excursions . . . and so much more.

## **Transportation**

A full-time, certified chauffeur is available through the community's transportation department. Scheduled services take residents to nearby medical appointments, shopping trips, religious services, banks, postal services and more.

## **Pet Friendly**

Pets are part of the family, so Pacifica Senior Living communities are pet friendly\* and have designated pet areas for convenience.

*\*Weight limitations*







# PACIFICA

## SENIOR LIVING

For a list of Pacifica Senior Living  
communities, visit our website at  
[www.pacificaseniorliving.com](http://www.pacificaseniorliving.com)

FULL-SERVICE RETIREMENT LIVING